



**16mm Rotary type Encoders**



**Part Number**

**ED1612 – 20P – 20C – 25 F**

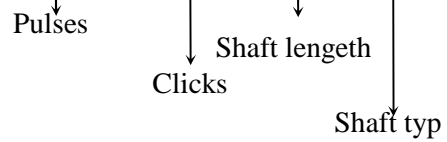

**Dimensions**

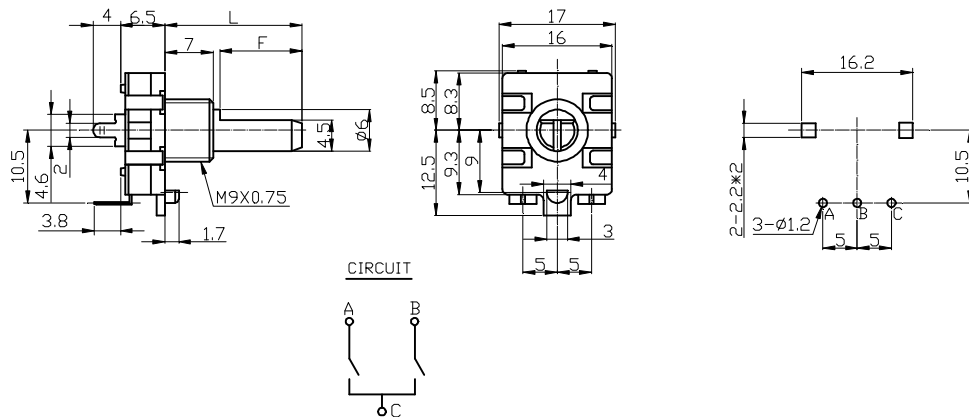

Available Clicks	0 clicks		12 clicks	24 clicks
Available Pulses	12 pulses	24 pulses	12 pulses	24 pulses

**Shaft Type**

F-TYPE

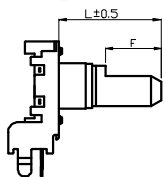

L	15	20	25	30
F	7	12	12	12

KC-TYPE

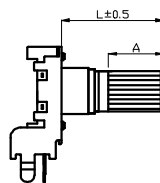

L	15	20	25	30
A	7	10	12	12



## 16mm Rotary type Encoders

### 1. Electrical Characteristics

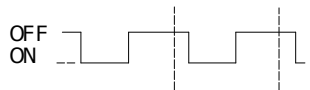
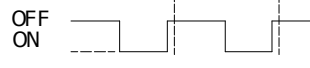
Power Rating	DC 5V 0.5mA
Insulation Resistance	More than 10 MΩ at DC 50V 1 Minute
Withstand Voltage	1 Minute at AC 50V
Sliding Noise	T2 ≤ 2mS (Test conditions: 360°/S) Using the C/R filter circuit is Recommended
Resolution	<input type="checkbox"/> 12. <input type="checkbox"/> 24 Pulses/360° for each phase /360°
Phase Difference	$\Delta T = 0.25 \pm 0.17T$
Output Signal and Rotational Direction	C.W direction <div style="display: flex; align-items: center;"> <div style="margin-right: 20px;">A Signal</div>  </div> <div style="display: flex; align-items: center; margin-top: 5px;"> <div style="margin-right: 20px;">B Signal</div>  </div>
Working Temperature	-10°C ~ 70°C
Storage Temperature	-40°C ~ 85°C

### 2. Mechanical Characteristics

Total Rotational Angle	360 °
Rotational Torque	<input type="checkbox"/> LC30~ 90gf.cm , <input type="checkbox"/> LLC 10~ 50gf.cm , <input type="checkbox"/> HC 90~ 150gf.cm Shaft Rota table at -10 °C ~ 5 °C
Shaft Push-Pull Strength	<input type="checkbox"/> With switch 5.1 Kgf. <input type="checkbox"/> on without switch 10 Kgf.
Number and Position Detent	<input type="checkbox"/> 12 detents (Step angle: 30° ± 3°) <input type="checkbox"/> 24 detents (Step angle: 15° ± 3°)
Rotational Life	30,000 Cycles Min. at a speed of 600cycles/H
Resistance To soldering Heat	Manual Soldering: Less than 300°C and quicker than 3 seconds.